

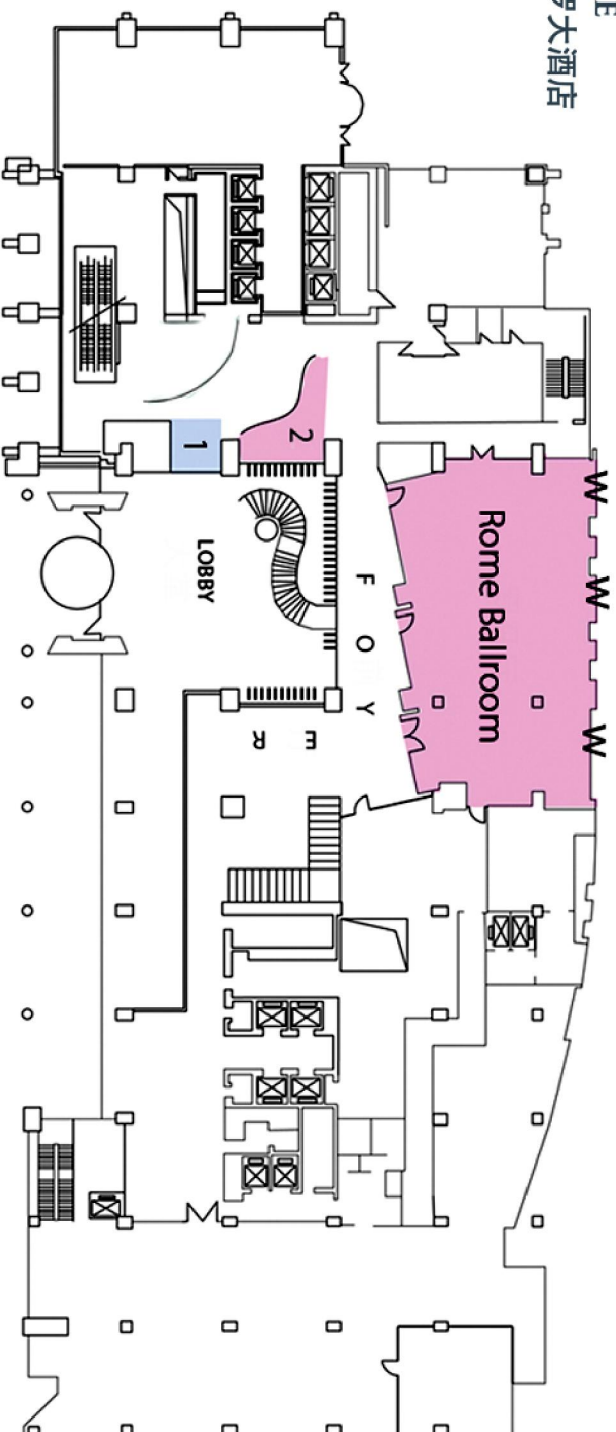

# MARCO POLO

PARKSIDE

北京中奥马哥亭罗大酒店



2/F

1. Secretariat Rome Ballroom: 320 m<sup>2</sup> Ceiling Height: 2.8 m
2. Media Lounge W = Window

| BALLROOM / MEETING ROOM | DIMENSIONS           |          |           |           | CAPACITY/person |           |           |         |       |
|-------------------------|----------------------|----------|-----------|-----------|-----------------|-----------|-----------|---------|-------|
|                         | Area /m <sup>2</sup> | Length/m | Breadth/m | Height /m | Theatre         | Classroom | Reception | U-Shape | Round |
| Rome                    | 320.0                | 25.0     | 12.7      | 2.8       | 200             | 150       | 200       |         | 180   |



MARCO POLO

PARKSIDE

北京中奥马哥孛罗大酒店

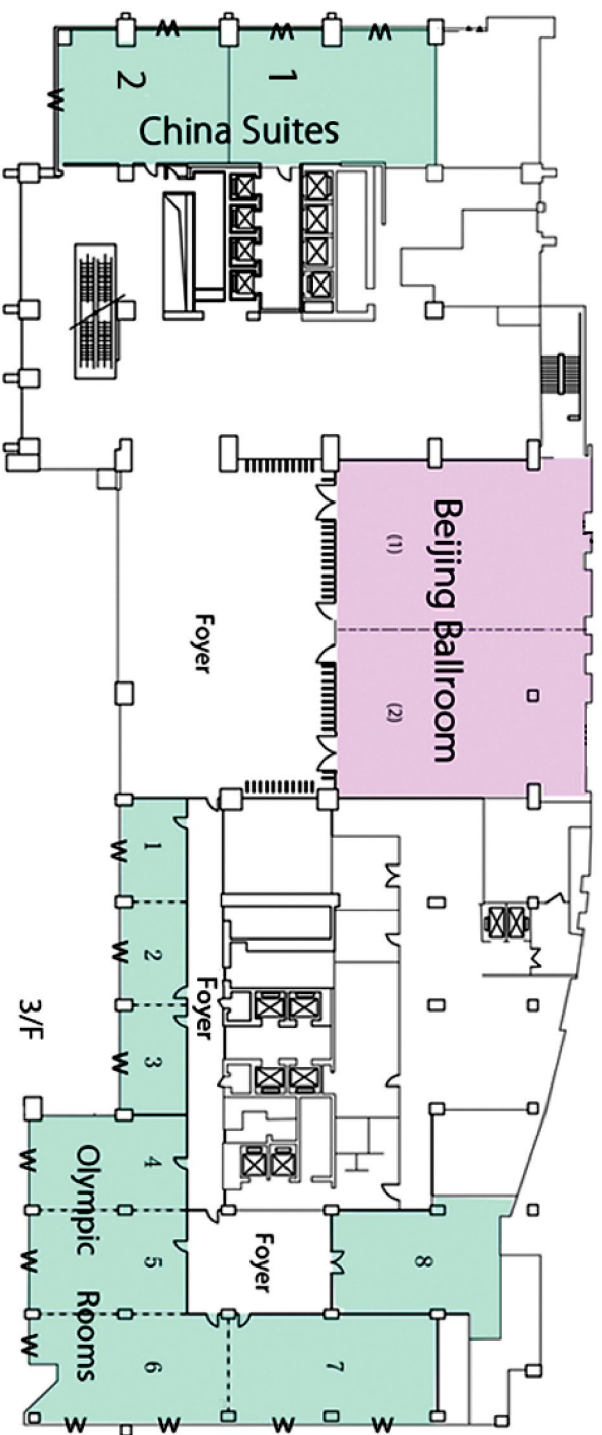

Beijing Ballroom: 500 m<sup>2</sup>

Ceiling Height: 6.25 m

W = Window

| BALLROOM / MEETING ROOM | DIMENSIONS           |           |            |           | CAPACITY/person |           |           |         |       |
|-------------------------|----------------------|-----------|------------|-----------|-----------------|-----------|-----------|---------|-------|
|                         | Area /m <sup>2</sup> | Length /m | Breadth /m | Height /m | Theatre         | Classroom | Reception | U-Shape | Round |
| Beijing                 | 500.0                | 28.0      | 18.0       | 6.25      | 350             | 270       | 300       | 60      | 280   |
| Beijing 1               | 250.0                | 18.0      | 14.0       | 6.25      | 175             | 135       | 160       | 60      | 130   |
| Beijing 2               | 250.0                | 18.0      | 14.0       | 6.25      | 175             | 135       | 160       | 60      | 130   |
| Beijing Foyer           | 470.0                |           |            |           |                 |           |           |         |       |

10 Function rooms

| FUNCTION ROOM  | DIMENSIONS           |           |            |           | CAPACITY/person |           |           |         |       |       |
|----------------|----------------------|-----------|------------|-----------|-----------------|-----------|-----------|---------|-------|-------|
|                | Area /m <sup>2</sup> | Length /m | Breadth /m | Height /m | Theatre         | Classroom | Reception | U-Shape | Round | Board |
| Olympic Room 1 | 40.00                | 8.0       | 5.00       | 2.7       | 50              | 24        | 30        | 20      | 20    | 22    |
| Olympic Room 2 | 40.00                | 8.0       | 5.00       | 2.7       | 50              | 24        | 30        | 20      | 20    | 22    |
| Olympic Room 3 | 40.00                | 8.0       | 5.00       | 2.7       | 50              | 24        | 30        | 20      | 20    | 22    |
| Olympic Room 4 | 70.00                | 10.0      | 7.00       | 2.7       | 70              | 45        | 50        | 26      | 40    | 34    |
| Olympic Room 5 | 70.00                | 10.0      | 7.00       | 2.7       | 70              | 45        | 50        | 26      | 40    | 34    |
| Olympic Room 6 | 105.00               | 15.0      | 7.00       | 2.7       | 100             | 54        | 70        | 32      | 50    | 42    |
| Olympic Room 7 | 98.00                | 14.0      | 7.00       | 2.7       | 90              | 54        | 60        | 32      | 50    | 36    |
| Olympic Room 8 | 70.00                | 10.0      | 7.00       | 2.7       | 70              | 45        | 50        | 26      | 40    | 34    |
| China Suite 1  | 156.00               | 13.0      | 12.00      | 2.7       |                 |           | 80        |         | 20    |       |
| China Suite 2  | 144.00               | 12.0      | 12.00      | 2.7       |                 |           | 80        |         | 20    |       |